

# Sellstrom/RTC® SkyRider™ Bypass System

## Installation, Operating & Maintenance Instructions

### SM/RTC Sky-Rider™ Bypass System



**To the Equipment User:  
You must read and fully understand or have the following instructions explained to you before using this equipment. Failure to do so could result in serious or fatal injury.**

### WARNINGS

**To the Receiver, Contractor, Store Manager, Safety Director, Supervisor, Buyer, or anyone except the ultimate equipment users:**

These instructions are not to be removed except by the user of this equipment. Current instructions must always be available to any potential user.

Note: Because of continuous developments in the application and use of SM/RTC equipment and our desire to serve your best interests, these instructions are invalid 10 years after the effective date on these instructions. If these instructions are out of date, call SM/RTC Customer Service and request current instructions.

If you have difficulty or experience any problem with SM/RTC equipment or the instructions, call SM/RTC immediately and ask the Customer Service department for assistance.

The equipment purchased is designed to be used as a part of a complete fall protection or emergency rescue system and is to be inspected and maintained regularly.

**Atencion: Si usted no puede leer el ingles o si usted no comprende estas instrucciones, favor de consultar su director de seguridad o su supervisor.**

**Attention: Si vous ne pouvez pas lire l'anglais ou si vous ne comprenez pas les instructions, consultez votre directeur de securite ou votre superviseur.**

**Achtung: Wenn Sie nicht Englisch lesen können und diese Anweisungen nicht verstehen, dann fragen Sie bitte Ihren Sicherheitsdirektor oder Ihren Aufseher.**

**Attenzione: Se non legghiere l'inglese o non capite queste istruzioni, per favore rivolgete Vi al Vostro Direttore, responsabile della "Sicurezza sul Lavoro" o al Vostro diretto superiore.**

You assume complete liability if you fail to follow these instructions and are injured. Use this equipment only as instructed.

Warning: All SM/RTC equipment should be a part of a complete SM/RTC fall protection or emergency rescue system. If the buyer or user chooses to disregard this warning, he is solely responsible for the safety of the entire system and all users.

Before replacing or adding components to a fall protection or emergency escape system, consult the original manufacturer. Federal OSHA states that any unauthorized substitution or change to a system by the buyer should be fully evaluated or tested by a qualified person before the new system is put into use (see OSHA 1926.500).

All potential users of this equipment and user's management must read and understand all instructions fully; failure to do so could result in serious or fatal injury.

No fall arrest system can guarantee that you will not sustain injuries if a fall occurs. The most you can expect is that injuries will be substantially reduced. Improper use of this equipment will vastly increase your chances of serious injury or death because misuse builds false security. To achieve the maximum level of safety that this equipment is capable of providing, all instructions must be followed diligently. This means careful planning of your application and work method.

### 1.0 Approved Application

Sellstrom/RTC's (SM/RTC) SkyRider™ Bypass systems provide hands free ways past intermediate anchor points on SM/RTC horizontal lifelines. The Permacable® SkyRider is designed only for use on SM/RTC 5/8" Permacable.

Use of this equipment near physical or environmental hazards may require additional precautions. Contact SM/RTC if you have any questions or concerns.

#### Warning

Do not use with any other applications, nor employ any other method of use, without prior written approval.

#### Warning

Use only with SM/RTC horizontal lifelines.

### 2.0 System Parameters

SM/RTC has provided information regarding anchorage strength, clearance and other horizontal lifeline parameters with each horizontal lifeline system. Observance of these parameters is critical to the user's safety. Verify this information before installing a SkyRider system. Please contact SM/RTC if you have any questions about this information or your application.

**IMPORTANT:** For horizontal lifelines, you must design and install the anchorages according to the instructions provided, using a safety factor of at least two. Anchorages for horizontal lifelines may require anchorage strengths of greater than 5,000 lb. Refer to the information provided by SM/RTC with each horizontal lifeline for anchorage requirements.

Sellstrom Manufacturing Co.  
One Sellstrom Drive  
Palatine, IL 60067  
Phone 800.323.7402  
Fax 847.358.8564  
www.fallprotection.com

**sellstrom / RTC®**

# Sellstrom/RTC® SkyRider™ Bypass System

## Installation, Operating & Maintenance Instructions

### 3.0 Installation and Attachment

3.1 Inspect the system according to section 8.0.

3.2 Verify that the anchorages and the clearance below the walking or working surface meet the requirements in the instructions for the horizontal lifeline system that you will be using. Horizontal lifelines must be designed and installed as part of a complete personal fall arrest system, which maintains a safety factor of at least two, under the supervision of a qualified person. If you have any questions or concerns, contact SM/RTC.

3.3 Installation:

3.3.1 Install the horizontal lifeline, connecting the cable ends according to the instructions provided with the horizontal lifeline system. Ensure that the intermediate anchors are oriented as shown below.

3.3.2 Connect the intermediate anchorage brackets to the anchorage structure using fasteners or welding that meet the strength requirements provided by SM/RTC. The intermediate anchorage tube must be in line with the cable and the end anchorages. The flat side of the anchorage connector must be face up and horizontal as shown below. Preliminary tensioning may be necessary to position anchors.

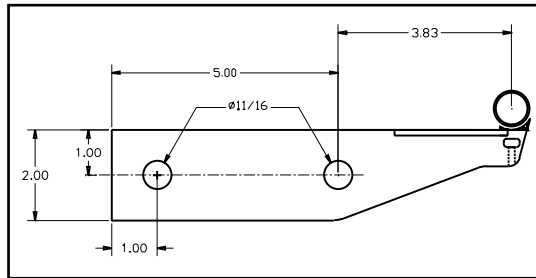

3.3.3 Tension the cable according to the correct tension listed in the corresponding horizontal lifeline instructions. Do not use the static sag method of tensioning the lifeline. Tension all cables of more than 200 ft. to 1260 lb. For example: If the entire length of the cable system is 300 ft., the correct tension is 1260 lb. For your convenience, the SM/RTC horizontal-lifeline-tensioning device may be used to indicate the correct tension.

3.3.4 Insert the plastic shim between the bottom of the cable and the intermediate anchorage tube. Wrap both ends of the shim around the bottom of the tube and through the retention slot in the intermediate anchorage. Tighten the setscrew to keep the shim in place. Note: The shim must be in place for smooth operation.



3.4 Connect the SkyRider bypass device as shown in the steps below:

3.4.1 Remove the quick release pin and rotate the plates open.



3.4.2 Place the SkyRider device on the cable with the sprocket facing the anchorage side of the cable.

3.4.3 Rotate the plates closed and replace the quick-release pin, ensuring that the pin is fully engaged.



Sellstrom Manufacturing Co.  
One Sellstrom Drive  
Palatine, IL 60067  
Phone 800.323.7402  
Fax 847.358.8564  
www.fallprotection.com

# Sellstrom/RTC® SkyRider™ Bypass System

## Installation, Operating & Maintenance Instructions

### 3.0 Installation and Attachment

*Continued*

#### Warning



Never use the SkyRider without closing the gate and securing it with the pin.

3.4.4 Connect the self-retracting lanyard or shock-absorbing lanyard to the SkyRider using a carabiner.



### 4.0 Operating Instructions

You must follow these instructions carefully in order for this equipment to provide you with needed fall protection. Notify your supervisor or the safety department immediately if you have any concerns about the condition of the equipment, or if you experience any problems, or if you do not understand the provided instruction sheet. Never take chances.

Connect the shock-absorbing lanyard or self-retracting lanyard to the back D-ring of the full body harness. Work under the

horizontal lifeline system, always keeping the SkyRider overhead. The SkyRider may not bypass the intermediate anchorages if the worker moves too far laterally from the horizontal lifeline. Avoid swing fall hazards.

Use only as directed in the corresponding instructions provided with each horizontal lifeline system.

### 5.0 Training

Conduct all training under the supervision of careful and competent managers. Live, hands-on training is essential to teach all users the capabilities and limitations of their personal protective equipment. Training promotes confidence. Follow up

introductory training with regular review and practice. Training should be site-specific. Store this instruction booklet where users can review it easily whenever necessary.

### 6.0 Rescue

The user must have a rescue plan and the means at hand to implement it in the event of a fall. Although every scenario

cannot be anticipated, develop a rescue plan that is tailored specifically for each worksite.

### 7.0 Inspection

7.1 I Inspect the SkyRider before every use. Also, ensure that a competent person other than the user inspects the SkyRider at least every six months. This "competent person inspection" is referred to as formal inspection. You must maintain a detailed record of inspection dates. A sample inspection and maintenance log is provided at the end of these instructions.

#### Warning



Do not use the equipment if damage is found or if you have questions or doubts about the equipment's condition. Tag the system "DO NOT USE" and contact SM/RTC Customer Service for advice.

7.2 Inspect all hardware, anchorages, brackets, welded joints and cable for cuts, burns, corrosion, burrs, cracks, dents, distortion, abrasion and any other signs of wear or damage. Immediately remove the cable from service and replace it with a new cable and/or hardware if you find any cuts, wearing or abrasions to the cable or hardware. Also, remove the cause of the damage from the system.

7.3 Inspect the following and ensure that:  
Intermediate anchor brackets are straight. Bolts are not bent. Cables are not cut or frayed. Plastic shims are in place.

7.4 Inspect the horizontal lifeline system according to the instructions provided with that system.

7.5 Inspect all other equipment, including full body harnesses and fall arrestors, according to the instructions provided with the equipment.

7.6 Ensure that labels on all SM/RTC equipment are secure and easy to read.

7.7 If the horizontal lifeline system is subjected to a fall, remove it from service immediately. Before returning to use, have a competent person inspect the entire SkyRider system, including the anchorage, according to these instructions. Especially check to ensure that the anchorages are straight, that bolts are not bent, that cables are not cut or frayed, and that no component of the system is deformed. Contact SM/RTC if any parts are damaged and need replacement.

Sellstrom Manufacturing Co.  
One Sellstrom Drive  
Palatine, IL 60067  
Phone 800.323.7402  
Fax 847.358.8564  
www.fallprotection.com

**sellstrom** / **RTC**®

# Sellstrom/RTC® SkyRider™ Bypass System

## Installation, Operating & Maintenance Instructions

### 8.0 Maintenance

**8.1** Maintain the personal protection equipment regularly to ensure that the equipment will operate properly when needed. Failure to maintain and store equipment carefully can result in poor operation that can lead to a serious or fatal injury. All equipment should be part of a periodic maintenance program that includes keeping detailed records of inspection and maintenance.

**8.2** Never make any adjustments or repairs to, nor substitute any parts of, the SM/RTC system. Do not take the bypass device apart. Call SM/RTC Customer Service for advice.

**8.3** Clean the SkyRider device regularly using a clean, dry cloth or brush.

**8.4** The SkyRider device may be lubricated periodically around the sprocket. Choose a suitable lubricant that does not attract dirt or grit.

### 9.0 Special Warnings

#### Warning



Never substitute parts of the SM/RTC SkyRider or horizontal lifeline system.

**9.1** Do not use this equipment in violation of any applicable company, state, or federal standard or requirement.

**9.2** Remove the horizontal lifeline, self-retracting lanyards, and harnesses from service immediately after a fall. Have a competent person inspect the entire SkyRider system, including anchorage, according to these instructions before returning to use. Call SM/RTC if any parts are damaged and need replacement.

**9.3** Never allow unauthorized parts to be used in or on the SkyRider system.

**9.4** Never permit usage where a swing fall hazard may occur.

**9.5** Anyone who has a history of back or neck problems that could be aggravated or complicated by using SM/RTC equipment should not do so. Pregnant women and minors should not use this equipment. Consult your doctor if there is any reason why you may not be able physically to absorb safely the forces subjected in the event of a fall arrest.

If you have any questions or need additional explanation or clarification about the use of any SM/RTC equipment, call SM/RTC Customer Service at 800-323-7402 (U.S. and Canada) or 847-358-2000 in Illinois or outside the Continental United States.

### 10.0 Inspection and Maintenance Log

PART NUMBER:									
Inspector									
Date									
INSPECTION ITEMS									
End Anchorages									
Intermediate Anchorage Brackets									
Welded Joints									
Bolts									
SkyRider									
Horizontal Lifeline									
Harnesses									
Fall Arrestors									
Labels									
Other									

Sellstrom Manufacturing Co.  
 One Sellstrom Drive  
 Palatine, IL 60067  
 Phone 800.323.7402  
 Fax 847.358.8564  
 www.fallprotection.com

