

Sellstrom/RTC® RailWalker®

Installation, Operating & Maintenance Instructions

SM/RTC RailWalker



To the Equipment User:
You must read and understand fully, or have the following instructions explained to you, before using this equipment. Failure to do so could result in serious or fatal injury.

WARNINGS To the Receiver, Contractor, Store Manager, Safety Director, Supervisor, Buyer, or anyone except the ultimate equipment users:

These instructions are not to be removed except by the user of this equipment. Current instructions must be available always to any potential user.

Note: Because of continual developments in the application and use of SM/RTC equipment and because of our desire to serve your best interests, these instructions are invalid 10 years after their effective date. If these instructions are out of date, call SM/RTC Customer Service and request current instructions.

If you experience any problems with SM/RTC equipment or the instructions, call SM/RTC immediately and ask the Customer Service department for assistance.

Use this equipment as a part of a complete fall protection or emergency rescue system. Inspect and maintain regularly.

Atencion: Si usted no puede leer el ingles o si usted no comprende estas instrucciones, favor de consultar su director de seguridad o su supervisor.

Attention: Si vous ne pouvez pas lire l'anglais ou si vous ne comprenez pas les instructions, consultez votre directeur de securite ou votre superviseur.

Achtung: Wenn Sie nicht Englisch lesen können und diese Anweisungen nicht verstehen, dann fragen Sie bitte Ihren Sicherheitsdirektor oder Ihren Aufseher.

Attenzione: Se non legghiere l'inglese o non capite queste istruzioni, per favore rivolgete Vi al Vostro Direttore, responsabile della "Sicurezza sul Lavoro" o al Vostro diretto superiore.

You assume complete liability if you fail to follow these instructions and are injured. Use this equipment only as instructed.

Warning: All SM/RTC equipment should be as part of a complete SM/RTC fall protection or emergency rescue system. If the buyer or user chooses to disregard this warning, he is solely responsible for the safety of the entire system and all users.

Consult the original manufacturer before replacing or adding components to a fall protection or emergency escape system. Federal OSHA states that any unauthorized substitution or change to a system by the buyer should be evaluated fully or tested by a qualified person before the new system is used (see OSHA 1926.500).

All potential users of this equipment and the users' management must read and understand all instructions fully; failure to do so could result in serious or fatal injury.

No fall arrest system can guarantee that you will not sustain injuries if a fall occurs. The most you can expect is that injuries will be substantially reduced. Improper use of this equipment will vastly increase your chances of serious injury or death because misuse builds false security. All instructions must be followed diligently to achieve the maximum level of safety that this equipment is capable of providing. This involves careful planning of your application and work method.

You assume complete liability if you fail to follow these instructions and are injured. Use this equipment only as instructed.

Warning: Complete System Components

A complete fall protection system consists of the following components that are arranged to fit the specific work task and control the elevated fall hazard(s):

Anchorage Point:

An anchorage is a secure means of attachment to which the personal fall arrest system is connected. (ANSI Z359.1)

Body Support:

A body support is the component of a personal fall protection system that is worn on or around the body. Full body harnesses must be used for all fall arrest systems.

Connecting Means:

A connecting means is the link between the body support and anchorage. It can be a shock-absorbing lanyard, rope grab, self-retracting lanyard or retrieval system. Connecting means will vary depending on the application.

The user must have at hand a rescue plan and the means to implement it in the event of a fall.

Note: More than one system may be needed for continuous protection.

Sellstrom/RTC® RailWalker®

Installation, Operating & Maintenance Instructions

1.0 Approved Application

The SM/RTC RailWalker is a horizontal fixed rail system. Rails can accommodate several trolleys (one per worker) at a time, however workers must maintain spacing of 6 ft. or more. The SM/RTC RailWalker is approved for use only in combination with a SM/RTC fixed rail system, full body harness and shock-absorbing lanyard or 2008 series Retractor®.

Anchorage Strength: The anchorage structure must be capable of supporting a minimum of 3,600 lb. when certification exists, or 5,000 lb. in the absence of certification. (See ANSI Z359.1 for definition of certification.) When more than one personal fall arrest system is attached to an anchorage, the anchorage's strengths above shall be multiplied by the number of personal

fall arrest systems attached to the anchorage. This requirement is consistent with OSHA requirements as follows: Anchorages used for attachment of personal fall arrest systems shall be independent of any anchorage being used to support or suspend platforms and capable of supporting at least 5,000 lbs. per user attached, or be designed, installed and used as part of a complete PFAS which maintains a safety factor of at least two and is supervised by a qualified person.

No other applications are allowed without the written approval of Sellstrom/RTC.

2.0 Performance Data

The designed working load is 310 lb. for individual use between structural attachment points. The equipment is designed to support the fall of a 310 lb. person with up to two feet of vertical free fall using an SM/RTC shock-absorbing lanyard or Retractor. Contact SM/RTC for more information when a longer self-retracting lanyard is needed.

The RailWalker system meets OSHA 1910.66, 1926.500, ANSI A10.14 and Z359.1 standards.

3.0 Training

All training must be conducted under careful and competent supervision. Live hands-on training for all users is essential to learn the capabilities and limitations of their personal protective equipment. Training promotes confidence and

should be conducted as an initial introduction, as well as periodically for review and practice. Store these instructions where users can review them easily whenever necessary.

4.0 Installation and Attachment

4.1 Anchorage Structure: Confirm anchorage meets strength requirements listed in section 1.0.

4.2 Fittings: Use the fitting assemblies to connect the rail system to the anchorage structure. The spacers are placed behind the rail. Fittings must be spaced no more than 4 ft. apart. Tighten the fittings to approximately 15 ft.- lb. of torque.

4.3 Rail: Slots in the stainless steel rail are spaced to accommodate fittings for most anchorage structures. If slots in the rail do not enable standard fittings to coincide with the structure every 4 ft., the rail may be field drilled with a 13/32" hole. Any drilling, if required, should be done at ground level to minimize fall hazard exposure.

4.4 Splice Plates: Join rails together with splice plates. Note: for aluminum rail, the head of the bolt slides into the slot on the backside of the aluminum rail. Make sure no gap exceeds 1/8" between rails to avoid accidental detachment of the RailWalker.

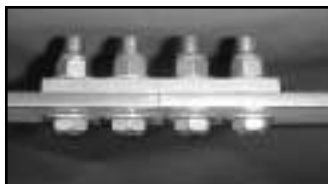

4.5 Attach RailWalker trolley as shown.



4.6 Install end stops. End stops should be installed between attachment fittings. If an end stop must be located beyond the last attachment fitting, it must not be more than 2" from the last fitting. End stops must be installed at each end.

4.7 Rail may be cut to length in the field. If necessary, use the illustration to field drill 13/32" diameter holes for the attachment of splice plates.

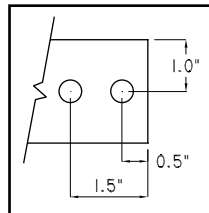

Sellstrom/RTC® RailWalker®

Installation, Operating & Maintenance Instructions

5.0 Operating Instructions

The user must inspect the RailWalker system and all other fall protection equipment before each use.

5.1 Attach the RailWalker trolley onto the end of the rail by sliding it inside the end stop "This End on Top" label and directional arrow indicate the proper position of the trolley on the rail. Do not expose yourself to a fall hazard during attachment or detachment. Never attach the RailWalker trolley in any other manner.

5.2 Make sure all four rollers glide along the rail smoothly by sliding the trolley back and forth before use.

5.3 Attachment to trolley:

5.3.1 Never attach any snaphook to the eye of the RailWalker device.

5.3.2 When a shock-absorbing lanyard is permanently attached to the trolley, attach the snap hook from the shock-absorbing lanyard to the back D-ring on the harness.

5.3.3 When an SM/RTC 2008 series Retractor is used with a trolley, attach the device to the trolley with the carabiner provided. Then attach the device snap hook to a back D-ring on the harness.

5.4 Do not expose yourself to any unnecessary fall hazard or swing fall hazard. For example, never reach out while using the RailWalker, which can expose you to a dangerous swing if you fall.

5.5 The RailWalker system may be used simultaneously by several persons (one trolley per person). Always maintain a space of 6 ft. between workers.

5.6 In the event of a fall, remove the RailWalker and all personal fall protection equipment from service. Mark, "DO NOT USE" until the equipment can be inspected by a qualified person. Refer to section 6.0. Contact SM/RTC Customer Service for advice.

6.0 Inspection

The user must inspect the RailWalker system and all other fall protection equipment before each use. In addition, a competent person other than the user must inspect the RailWalker system at least every six months.

Warning



If damage is found or you have questions or any doubts about the equipment's condition, do not use the equipment. Tag the system "DO NOT USE" and contact SM/RTC Customer Service for advice.

6.1 Inspect all rail fittings and splices. Re-tighten fittings when necessary. Do not over tighten bolts. The structural attachment points should have a snug fit. All rails must be continuous with no gaps that might cause accidental detachment of the RailWalker.

6.2 Minor nicks and scratches on the rail should not effect the smooth operation of the trolley. However, order a new piece of rail from SM/RTC and replace the section if dents or damage occur.

6.3 If a fall occurs, a qualified engineer should inspect the rail and determine if the trolley, rail or fittings have been structurally weakened. A new length of rail and/or fittings should be substituted if damage has occurred.

6.4 Trolley: Inspect the RailWalker trolley regularly before use to ensure smooth operation on the rail. If a shock-absorbing lanyard is permanently attached to the trolley, check the webbing for visible signs of damage. If a lanyard and/or harness are subjected to impact loading, remove from service immediately. Also, if the DANGER warning label on the shock-absorbing lanyard is visible, remove it from service immediately and contact SM/RTC for repair and re-certification. If an SM/RTC Retractor is used with the trolley,

make sure the carabiner closes securely onto the trolley attachment ring.

Ensure the rollers rotate freely for smooth operation, especially in cold temperatures, by lightly oiling regularly with a low temperature lubricant.

Check the trolley body for rough or sharp edges, corrosion, burrs, cracks, dents or distortion.

6.5 Snaphook: All snaphooks must operate smoothly and close and lock completely. Check for rough or sharp edges, corrosion, burrs, cracks, dents or distortion. Check rivets for broken, bent or cracked conditions. Gate and gate locks must be free from distortion, bending and must seat properly and securely against the snaphook nose and body. The gate and lock spring should cause these two parts to close firmly. Carabiners snaphooks should rotate freely into the closed and locked position when released

6.6 Personal protective equipment must be maintained regularly to help ensure that the equipment will operate properly when needed. Failure to maintain and store equipment carefully can result in poor operation that could lead to serious or fatal injury.

6.7 All equipment should be part of a periodic maintenance program, including detailed records. A minimum of every six months is suggested or more often if the equipment is heavily used.

6.8 Never adjust, repair, or substitute any parts of a SM/RTC system. You must return the RailWalker trolley for factory inspection and maintenance within two years of manufacture date and every two years thereafter.

Sellstrom/RTC® RailWalker®

Installation, Operating & Maintenance Instructions

6.0 Inspection *Continued*

6.9 Cleaning: The RailWalker trolley may be cleaned by brushing away any excess dirt or grit. The unit can be wiped with a clean damp cloth. Lubricate after cleaning.

6.10 Lubrication: The RailWalker trolley may be lubricated periodically with a dry silicone-based spray at pivot points. Do not use oil or grease that will attract dirt or grit. Do not grease, oil, or lubricate the Rail.

6.11 Threaded Fasteners: When servicing any of the threaded fasteners, use an anti-seize compound to prevent thread damage. An anti-seize compound is applied at the factory to all new threaded fasteners on the RailWalker system.

7.0 Special Warnings

Warning



7.1 Never adjust or tamper with the RailWalker trolley parts, nor use unauthorized snap hooks to attach to the RailWalker trolley.

7.2 Never substitute parts of the RailWalker Fall Protection System.

7.3 Never use a RailWalker trolley on any rail that is not horizontal, continuous-run (spliced) or has smaller dimensions than 1/4" x 2".

7.4 Never use a RailWalker trolley on a rail system without end stops installed at each gap or end. This may cause the trolley to come off, leading to serious injury or death.

7.5 Do not use this equipment in violation of any applicable OSHA or local standards.

7.6 Never install or use the RailWalker trolley upside down or partially fitted to the rail.

7.7 Never attach any snaphook to the eye of the RailWalker device.

7.8 Never attach a material load to the RailWalker device for material handling use. This device is intended as a personal trolley for fall protection only.

7.9 Never attach more than one person to a device, nor more than one device between rail attachment fittings.

7.10 Do not use where a swing fall hazard may occur.

7.11 Anyone who has a history of back or neck problems that could be aggravated or complicated by using SM/RTC equipment should not do so. Pregnant women and minors should not use this equipment. Consult your doctor if there is any reason why you may not be physically able to safely absorb the forces subjected to the user in the event of a fall arrest.

If you have any questions or need additional explanation or clarification about the use of any SM/RTC equipment, call SM/RTC Customer Service.

8.0 Inspection and Maintenance Log

PART NUMBER:									
Inspector									
Date									
INSPECTION ITEMS									
Trolley									
Lanyard									
Labels									
Splices									
Rail									
Fittings									
Anchorage Structure									
End Stops									
Other									

Sellstrom Manufacturing Co.
 One Sellstrom Drive
 Palatine, IL 60067
 Phone 800.323.7402
 Fax 847.358.8564
 www.fallprotection.com

